



EV Charging Team
Highways and Transportation
Tower Hamlets Council
Town Hall
160 Whitechapel Road
London
E1 1BJ

Email: EVCharging@towerhamlets.gov.uk

Web: <https://towerhamlets.govocal.com/en-GB/projects/lbth-rapid-chargers>

November 28th 2025

Dear Resident,

New rapid charging point proposed on Lowell Street

This document outlines our proposals for the introduction of an electric vehicle charging point and associated electric vehicle only bay. You can respond to this consultation online at:

<https://towerhamlets.govocal.com/en-GB/projects/lbth-rapid-chargers>.

Alternatively, you can email the address above, quoting reference 'LBTH Rapid Chargers' and make clear the locations(s) to which the representation refers.

The closing date for the return of the questionnaire is 5th January 2026.

Background

Tower Hamlets Council is looking to expand its electric vehicle charging network to further support the adoption of low emission electric vehicles and reduce air pollution across the borough. The demand for Electric Vehicle (EV) in Tower Hamlets is very high and continue to grow annually. To meet the demands of this growth the council is working to add more charging points to its existing network.

What is being proposed

We are proposing to introduce a double charging point on Lowell Street which will serve two bays. One is a residential parking bay that will not be changed. The other bay will be converted to a dedicated bay where only electric vehicles will only be able to park if they are charging.

Please see attached, a photo of the proposed location, an example of what the electric vehicle charge point looks like and plans.

Yours sincerely,

Tower Hamlets Council.

Proposed Location



Example Charging Point



Proposed Plan

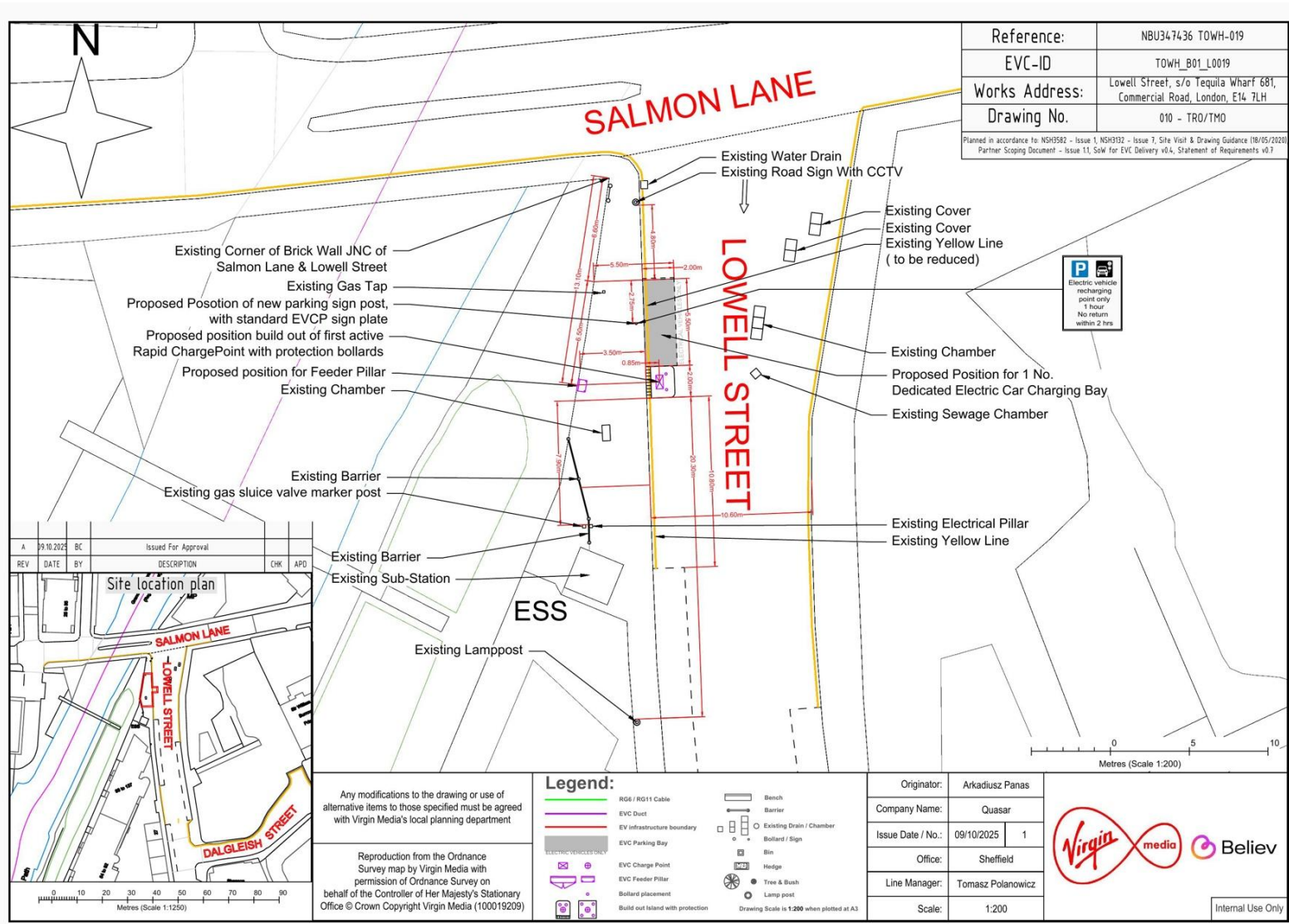

Reference:	NBU347436 TOWH-019
EVC-ID	TOWH_B01_L0019
Works Address:	Lowell Street, s/o Tequila Wharf 681, Commercial Road, London, E14 7LH
Drawing No.	010 - TR0/TMO

Planned in accordance to NSH0582 - Issue 1, NSH0302 - Issue 7, Site Visit & Drawing Guidance (18/05/2020) Partner Scoping Document - Issue 11, SoW for EVC Delivery v04, Statement of Requirements v0.7

REV	DATE	BY	DESCRIPTION	CHK	APD
A	09/10/2025	BC	Issued For Approval		

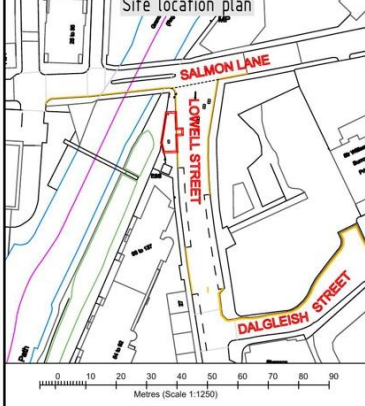

Any modifications to the drawing or use of alternative items to those specified must be agreed with Virgin Media's local planning department.

Reproduction from the Ordnance Survey map by Virgin Media with permission of Ordnance Survey on behalf of the Controller of Her Majesty's Stationary Office © Crown Copyright Virgin Media (100019209)

Legend:	
	RG6 / RG11 Cable
	EVC Duct
	EV Infrastructure boundary
	EVC Parking Bay
	EVC Charge Point
	EVC Feeder Pillar
	Bollard placement
	Build out island with protection
	Bench
	Barrier
	Existing Drain / Chamber
	Bollard / Sign
	Bin
	Hedge
	Tree & Bush
	Lamp post

Drawing Scale is 1:200 when plotted at A3

Originator:	Arkadiusz Panas
Company Name:	Quasar
Issue Date / No.:	09/10/2025 / 1
Office:	Sheffield
Line Manager:	Tomasz Polanowicz
Scale:	1:200

Internal Use Only